

Firchow, Kevin

From: Ted Halbach [tjhalbach@wisc.edu]
Sent: Thursday, May 15, 2008 10:35 AM
To: Firchow, Kevin
Cc: Tyler Smith; Melissa Destree
Subject: 5229 Harbor Court Lake Frontage

Dear Mr. Firchow,
Attached you will find our landscape plan. The goals of our plan are to maximize green space, preserve existing trees wherever possible and retain storm water on the property. The three trees currently located on the lake frontage will each remain and the hedgerow will be replaced by a rain garden consisting of perennial plants - plant species are listed on the plan. The rain garden is part of our storm water retention strategy. Also, notice that the driveway and lake side patio will be constructed from permeable pavers, further lessening storm water run-off from the property. Feel free to contact me if you have any additional question regarding this area of our plan.
Regards,
Ted and Sandy Halbach
608-833-5491

Firchow, Kevin

From: Ted Halbach [tjhalbach@wisc.edu]
Sent: Friday, May 16, 2008 9:50 AM
To: Firchow, Kevin
Cc: Melissa Destree
Subject: Re: 5229 Harbor Court Lake Frontage

Kevin,
The other thing, currently the soil around the hedge (about 5 feet in from the harbor wall) is uncovered with erosion going directly into the harbor. Our landscape plan fixes the problem.
Regards,
Ted

----- Original Message -----
From: [Firchow, Kevin](#)
To: [Ted Halbach](#) ; [melissa@destreearchitects.com](#)
Sent: Thursday, May 15, 2008 12:04 PM
Subject: RE: 5229 Harbor Court Lake Frontage

Thanks for the information. I will make copies of this information and the info from Melissa Destree and hand it out to the commission before the meeting.

Please let me know if you have questions.

Kevin Firchow, AICP
Planner, Planning Division

City of Madison Department of Planning &
Community and Economic Development

608.267.1150 (p)
608.267.8739 (f)

Madison Municipal Building Suite LL-100
215 Martin Luther King, Jr. Blvd.
PO Box 2985
Madison, Wisconsin 53701-2985

5229 Harbor Court. Photos of existing vegetation – supplied by applicant

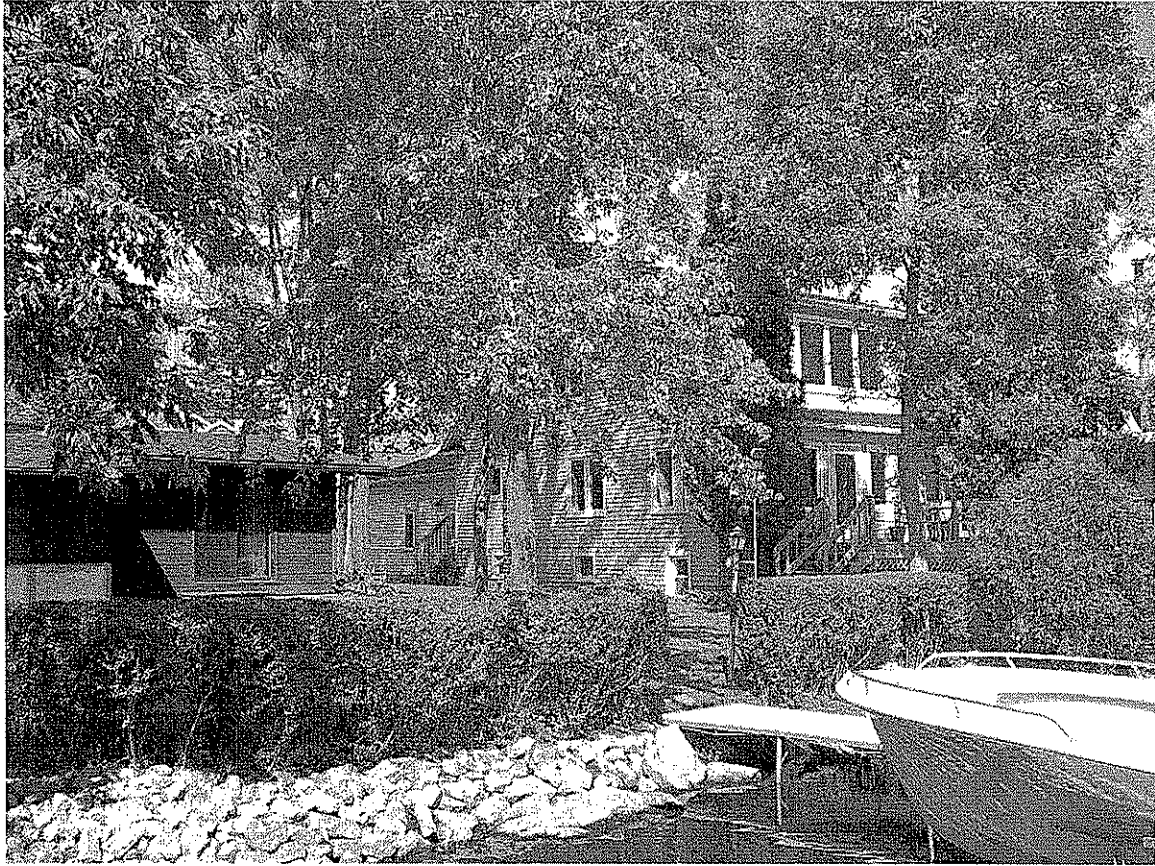

LANDSCAPING PLAN

SCALE: 1" = 10'-0"

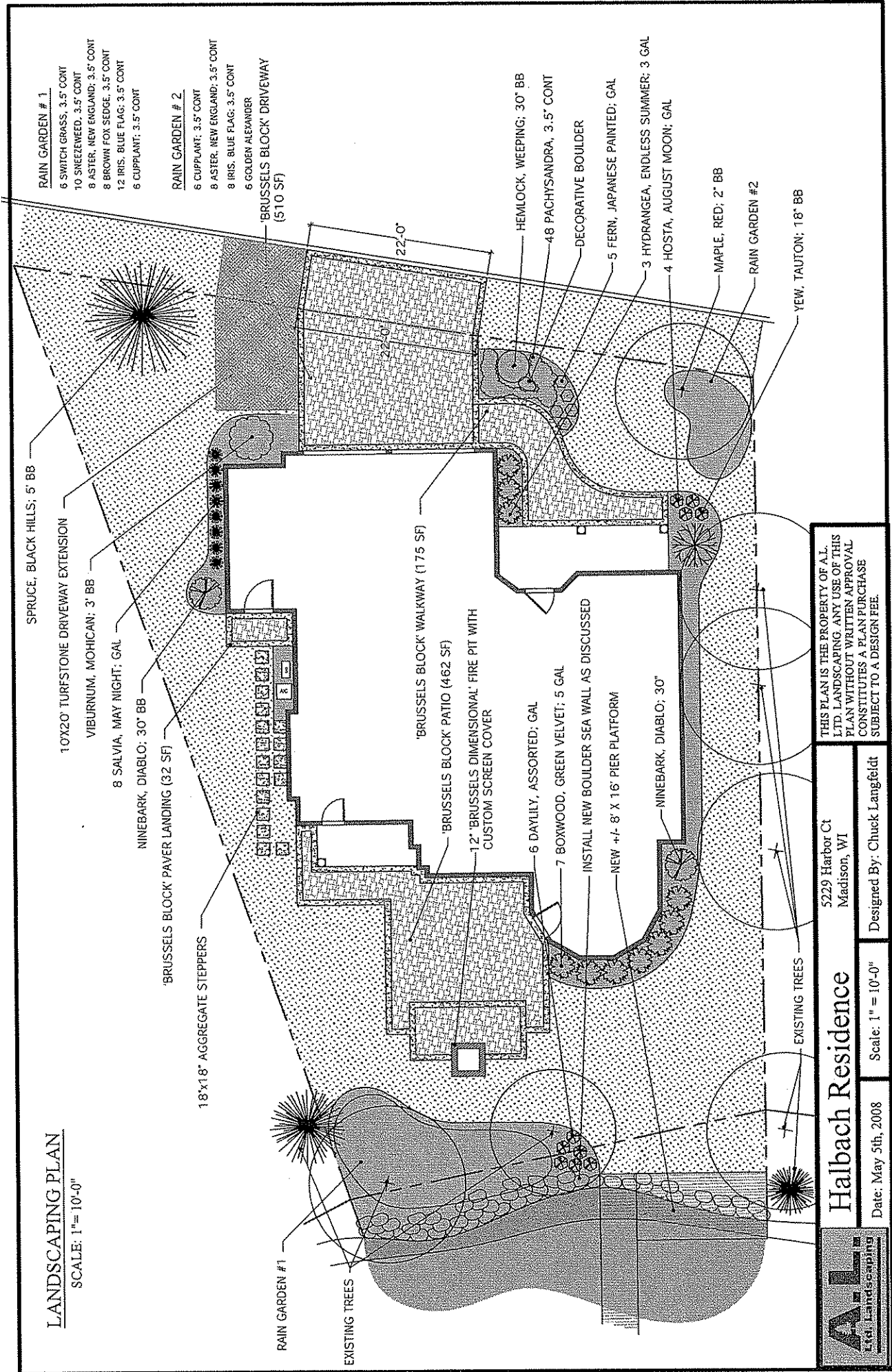

- RAIN GARDEN # 1**
- 6 SWITCH GRASS, 3.5' CONT
 - 10 SNEEZEED, 3.5' CONT
 - 8 ASTER, NEW ENGLAND, 3.5' CONT
 - 8 BROWN FOX SEDGE, 3.5' CONT
 - 12 IRIS, BLUE FLAG, 3.5' CONT
 - 6 CUPPLANT, 3.5' CONT

- RAIN GARDEN # 2**
- 6 CUPPLANT, 3.5' CONT
 - 8 ASTER, NEW ENGLAND, 3.5' CONT
 - 8 IRIS, BLUE FLAG, 3.5' CONT
 - 6 GOLDEN ALEXANDER

THIS PLAN IS THE PROPERTY OF A.L. LTD. LANDSCAPING. ANY USE OF THIS PLAN WITHOUT WRITTEN APPROVAL CONSTITUTES A PLAN PURCHASE SUBJECT TO A DESIGN FEE.

5229 Harbor Ct
Madison, WI

Halbach Residence

Designed By: Chuck Langfeldt

Scale: 1" = 10'-0"

Date: May 5th, 2008

