



# City of Madison Liquor/Beer License Application

On-Premises Consumption: ☒ Class B Beer ☒ Class B Liquor ☐ Class C Wine  
Off-Premises Consumption: ☐ Class A Beer ☐ Class A Liquor

## Section A – Applicant

1. This application is for the license period ending June 30, 2013.
2. List the name of your ☐ Sole Proprietor, ☐ Partnership, ☐ Corporation/Nonprofit Organization or ☒ Limited Liability Company exactly as it appears on your State Seller's Permit.  
Chipotle Mexican Grill of Colorado, LLC
3. Trade Name (doing business as) Chipotle Mexican Grill #533
4. Address to be licensed 8422 Old Sauk Road Madison, WI 53562
5. Mailing address Attn: Licensing, 1401 Wynkoop Street, Suite 500, Denver, CO 80202
6. Anticipated opening date Opened 12/15/2003
7. State Seller's Permit 4 5 6 - 0 0 0 3 4 2 1 6 1 6 - 0 2
8. Federal Employer Identification Number 84-1485992
9. Is the applicant an employee or agent of, or acting of behalf of anyone except the applicant named in question 2?  
☒ No ☐ Yes (explain) \_\_\_\_\_
10. Does another alcohol beverage licensee or wholesale permittee have interest in this business?  
☒ No ☐ Yes (explain) \_\_\_\_\_

## Section B—Premises

11. Describe in words the building or buildings where alcohol beverages are to be sold and stored. Include all rooms including living quarters, if used, and any outdoor seating used for the sales, service, and/or storage of alcohol beverages and records. Alcohol beverages may be sold and stored only on the premises as approved by Common Council and described on license.

This facility is comprised of one large dining area, kitchen, rest rooms, and office. Alcoholic beverages will be stored behind the point of sale counter as well as in the back of the house. Outdoor dining is located to the right of the main entrance. See attached plan for furniture layout.

12. ☒ Attach a floor plan, no larger than 8 ½ by 14, showing the space described below.
13. Applicants for on-premises consumption: list estimated capacity 55 Indoor, 24 Outdoor

#29590

14. Describe existing parking and how parking lot is to be monitored.

Public parking available on surrounding streets.

15. Was this premises licensed for the sale of liquor or beer during the past license year?

☐ No ☒ Yes, license issued to Chipotle Mexican Grill of Colorado, LLC (name of licensee)

16. ☒ Attach copy of lease.

### Section C—Corporate Information

This section applies to corporations, nonprofit organizations, and Limited Liability Companies only. Sole proprietorships and partnerships, skip to Section D.

17. Name of liquor license agent Brian J. Bushaw

18. City and state in which agent resides Madison, WI

19. ☒ Appointment of agent form and background check form are attached.

20. Has the liquor license agent completed the responsible beverage server training course?

☐ No, but will complete prior to ALRC meeting ☒ Yes, date completed 1/30/2013

21. State and date of registration of corporation, nonprofit organization, or LLC.

Colorado

22. In the table below list the directors of your corporation or the members of your LLC.

☒ Attach background check forms for each director/member.

Title	Name	City and State of Residence
LLC Manager	M. Steven Ells	New York, NY
LLC Manager	Montgomery F. Moran	Boulder, CO

23. Registered agent for your corporation or LLC. This is your agent for service of process, notice or demand required or permitted by law to be served on the corporation. This is not necessarily the same as your liquor agent.

National Registered Agent

24. Is applicant a subsidiary of any other corporation or LLC?

☐ No ☒ Yes (explain) Chipotle Mexican Grill of Colorado, LLC is wholly owned and operated by Chipotle Mexican Grill, Inc which is publicly traded on the NSYE (CMG)

25. Does the corporation, any officer, any director, any stockholder, liquor agent, LLC, any member, or any manager hold any interest in any other alcohol beverage license or permit in Wisconsin?

☐ No ☒ Yes (explain) See attached list of Licenses held in Wisconsin

### Section D—Business Plan

26. What type of establishment is contemplated?

☐ Tavern ☐ Nightclub ☒ Restaurant ☐ Liquor Store ☐ Grocery Store  
☐ Convenience Store without gas pumps ☐ Convenience Store with gas pumps  
☐ Other \_\_\_\_\_

27. Business description Fast casual Mexican restaurant

28. Hours of operation Sunday - Saturday: 11:00am - 10:00pm

29. Describe your management experience \_\_\_\_\_

30. List names of managers below, along with city and state of residence.

Erin Grier, General Manager, Milwaukee, WI

Ashleigh Calvert, Madison, WI

Lester Rodriguez, Middleton, WI

31. Describe staffing levels and staff duties at the proposed establishment \_\_\_\_\_

Two shifts of approximately 8 employees per shift. Shifts from 8am - 4pm and 3pm - 11pm

32. Describe your employee training \_\_\_\_\_

See attached Corporate Training Manual related to Alcoholic Beverages sales.

33. Utilizing your market research, describe your target market.

We hope that the food at Chipotle is appealing to all people regardless of age, ethnicity or religious beliefs.

34. Describe how you plan to advertise and promote your business. What products will you be advertising?

Television and radio advertising

35. Are you operating under a lease or franchise agreement? ☐ No ☒ Yes
36. Private organizations (clubs): Do your membership policies contain any requirement of "invidious" (likely to give offense) discrimination in regard to race, creed, color, or national origin?  
☐ No ☐ Yes

### Section E—Consumption on Premises

This section applies to Class B and Class C applicants only. Class A license applicants (consumption off premises) may skip to Section F.

37. Do you plan to have live entertainment? ☒ No ☐ Yes—what kind? \_\_\_\_\_
38. What age range do you hope to attract to your establishment? There is no age range on delicious!  
(typical guest age range 18-99)
39. What type of food will you be serving, if any? \_\_\_\_\_  
☐ Breakfast ☐ Brunch ☒ Lunch ☒ Dinner
40. Submit a sample menu if applicable. What will be included on your operational menu?  
☐ Appetizers ☒ Salads ☐ Soups ☐ Sandwiches ☒ Entrees ☐ Desserts  
☐ Pizza ☐ Full Dinners
41. During what hours of operation do you plan to serve food? Sunday - Saturday: 11:00am - 10:00pm
42. What hours, if any, will food service not be available? None, we serve food the entire time we are open.
43. Indicate any other product/service offered. None
44. Will your establishment have a kitchen manager? ☐ No ☒ Yes
45. Will you have a kitchen support staff? ☒ No ☐ Yes
46. How many wait staff do you anticipate will be employed at your establishment? No wait staff  
During what hours do you anticipate they will be on duty? \_\_\_\_\_
47. Do you plan to have hosts or hostesses seating customers? ☒ No ☐ Yes
48. Do your plans call for a full-service bar? ☒ No ☐ Yes  
If yes, how many barstools do you anticipate having at your bar? \_\_\_\_\_  
How many bartenders do you anticipate having work at one time on a busy night? \_\_\_\_\_
49. Will there be a kitchen facility separate from the bar? ☒ No ☐ Yes

50. Will there be a separate and specific area for eating only?  
☒ No ☐ Yes, capacity of that area \_\_\_\_\_
51. What type of cooking equipment will you have?  
☐ Stove ☐ Oven ☐ Fryers ☐ Grill ☐ Microwave
52. Will you have a walk-in cooler and/or freezer dedicated solely to the storage of food products?  
☐ No ☒ Yes
53. What percentage of payroll do you anticipate devoting to food operation salaries? Payroll is processed through our payroll company
54. If your business plan includes an advertising budget:  
 What percentage of your advertising budget do you anticipate will be related to food? General advertising is done by regions and markets, and fluctuate as new locations open. No advertising done specifically for alcohol.  
 What percentage of your advertising budget do you anticipate will be drink related? \_\_\_\_\_
55. Are you currently, or do you plan to become, a member of the Madison—Dane County Tavern League or the Tavern League of Wisconsin? ☒ No ☐ Yes
56. Are you currently, or do you plan to become, a member of the Wisconsin Restaurant Association or the National Restaurant Association? ☒ No ☐ Yes
57. All restaurants and taverns serving alcohol must substantiate their gross receipts for food and alcohol beverage sales broken down by percentage. New establishments estimate percentages:  
2 or less % Alcohol 98 % Food zero % Other
58. Do you have written records to document the percentages shown? ☐ No ☒ Yes  
 You may be required to submit documentation verifying the percentages you've indicated.

## Section F—Required Contacts and Filings

59. I understand that liquor/beer license renewal applications are due April 15 of every year, regardless of when license was initially granted. ☐ No ☒ Yes
60. I understand that I am required to host an information session at least one week before the ALRC meeting. ☐ No ☒ Yes
61. I agree to contact the Alderperson for this location to discuss my application and to invite the Alderperson to my information session. ☐ No ☒ Yes
62. I agree to contact the Police Department District Captain for this location prior to the ALRC meeting. ☐ No ☒ Yes
63. I agree to contact the Alcohol Policy Coordinator prior to the ALRC meeting. ☐ No ☒ Yes
64. I agree to contact the neighborhood association representative prior to the ALRC meeting.  
☐ No ☒ Yes
65. I understand we must file a Special Occupational Tax return (TTB form 5630.5) before beginning business. [phone 1-800-937-8864] ☐ No ☒ Yes
66. I understand a Wisconsin Seller's Permit must be applied for and issued in the same name as that shown in section 2, above. [phone 608-266-2776] ☐ No ☒ Yes
67. Is the applicant indebted to any wholesaler beyond 15 days for beer or 30 days for liquor?  
☒ No ☐ Yes

## Section G—Contact Information for Clerk's Office

68. Who may we contact between 8 a.m. and 4:30 p.m. regarding this license?

Contact person Kay Bell or Kim Oganessian

E-mail address Licensing@Chipotle.com

Phone (303)222-2546

Preferred language for correspondence English

**Read carefully before signing in front of a notary:** Under penalty provided by law, the applicant states that the above information has been truthfully completed to the best of the knowledge of the signer. Signer agrees to operate the business according to law, and that the rights and responsibilities conferred by the license(s), if granted, will not be assigned to another. Lack of access to any portion of licensed premises during inspection will be deemed a refusal to permit inspection. Such refusal is a misdemeanor and grounds for revocation of this license.

Subscribed and Sworn to before me:

this 18 day of February, 2013

[Signature]  
(Clerk/Notary Public)

[Signature]  
(Officer of Corporation/Member of LLC/Partner/Sole Proprietor)  
Montgomery F. Moran, LLC Manager

My commission expires 8/24/16

**BRADLEY F. KARR**  
NOTARY PUBLIC  
STATE OF COLORADO  
NOTARY ID 20124054430  
MY COMMISSION EXPIRES 08/24/2016

### Clerk's Office checklist for complete applications

<input type="checkbox"/> Orange sign	<input checked="" type="checkbox"/> Background investigation form(s)	<input checked="" type="checkbox"/> Floor Plans
<input checked="" type="checkbox"/> WI Seller's Permit Certificate (matching articles of incorporation)	<input type="checkbox"/> Form for surrender of previous license	<input checked="" type="checkbox"/> Lease
<input checked="" type="checkbox"/> FEIN	<input checked="" type="checkbox"/> *Articles of Incorporation	<input checked="" type="checkbox"/> Sample Menu
<input checked="" type="checkbox"/> Notarized application	<input checked="" type="checkbox"/> *Notarized Appointment of Agent	
<input checked="" type="checkbox"/> Written description of premises	* Corporation/LLC only	

Date complete application filed with Clerk's Office \$ 2/26/13

Date of ALRC meeting 4/24/13 Date license granted by Common Council 5/7/13

Date provisional issued \_\_\_\_\_ Date license issued \_\_\_\_\_ License number LCHB-2013-00139

E.2

LEAVE 2" CLEARANCE BETWEEN  
BAR TOP & FACE OF WALL -  
TYP.  
SERVING LINE/P.O.S. COUNTER  
ASSEMBLY - REFER TO A400

D

E.5

UTENSIL COUNTER ASSEMBLY -  
REFER TO A430

REFER TO A450 & PLUMB. DWGS.  
FOR WASHING SYSTEM  
INSTALLATION @ MOP SINK

C

DOOR BELL - REFER TO ELEC.  
DGS. - INSTALL 60" A.F.F.  
CO-FILTER VALVE W/ LOOKING  
STAINLESS STL. COVER - INSTALL  
60" A.F.F.  
OFFICE DESK & SHELVING -  
REFER TO 8/420 - INSTALL  
DESK W/ 31" CLEAR BELOW

E

A

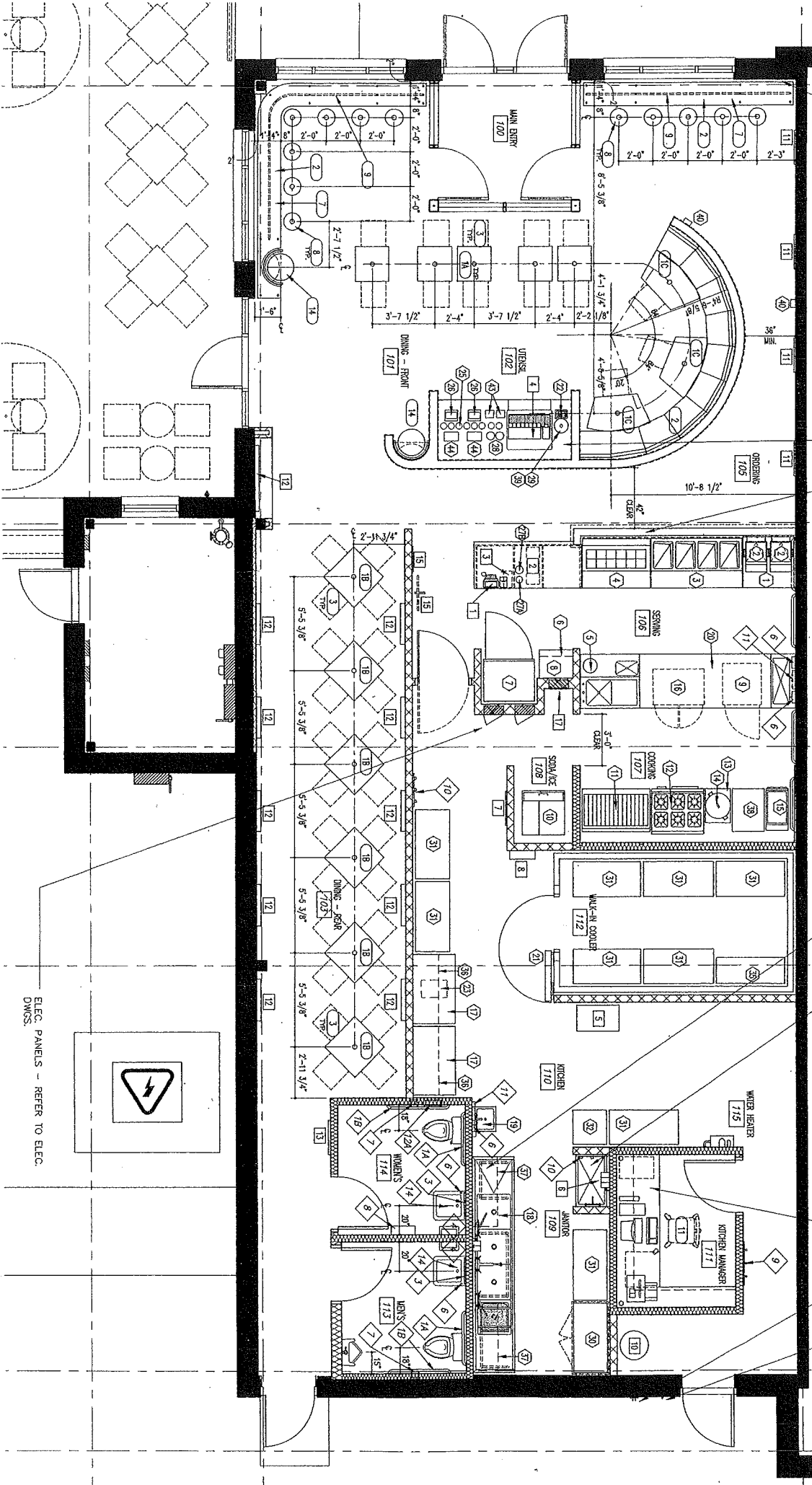

EQUIPMENT PLAN  
1/4" = 1'-0"

FURNITURE & MISCELLANEOUS  
#533

ELEC. PANELS - REFER TO ELEC.  
DWGS.