

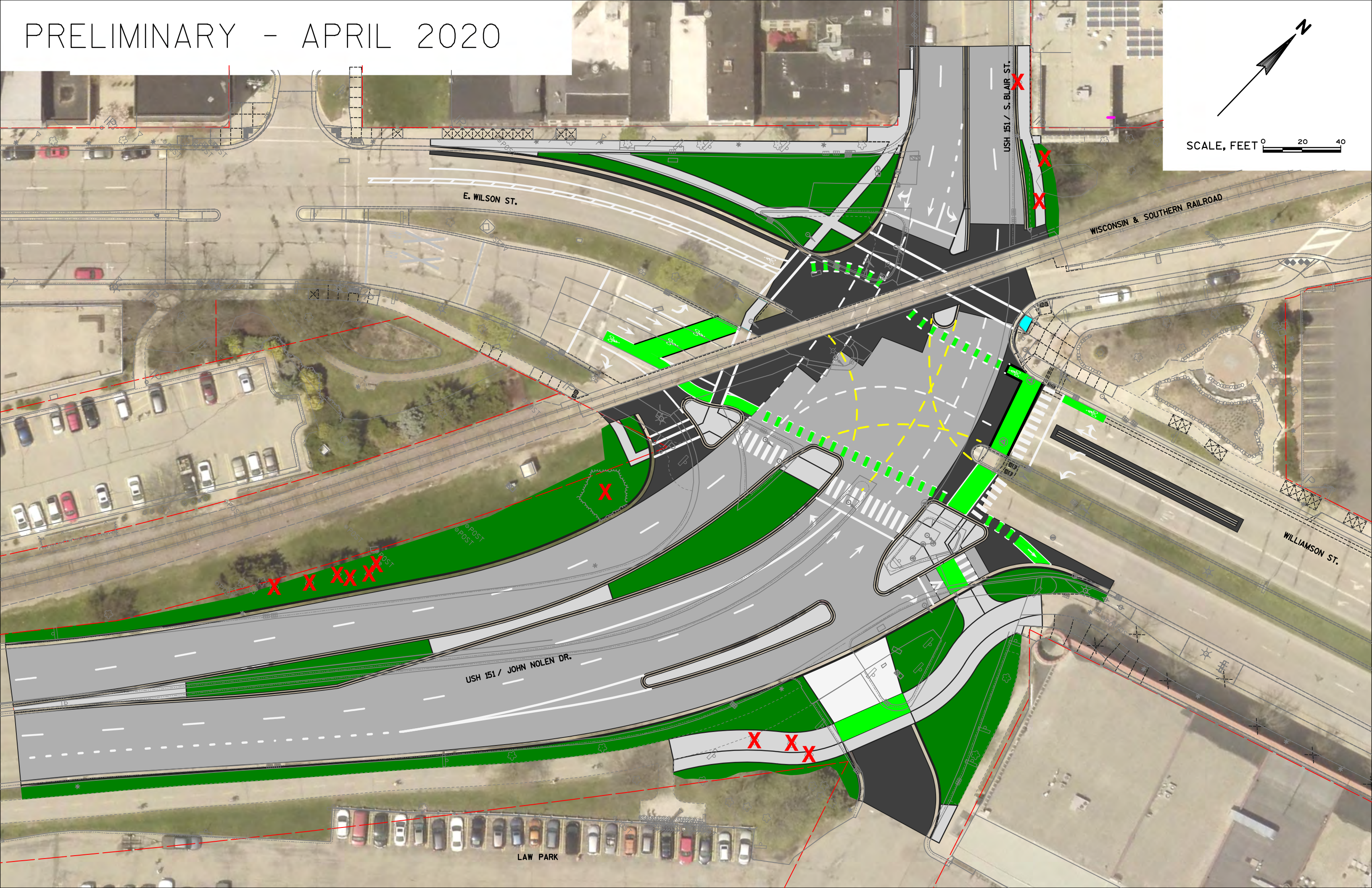

PRELIMINARY - APRIL 2020

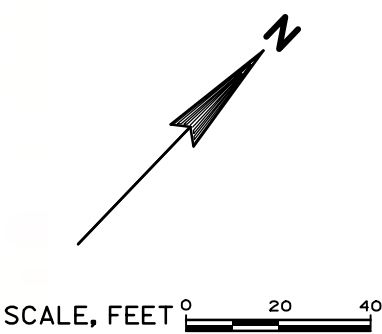



2

2

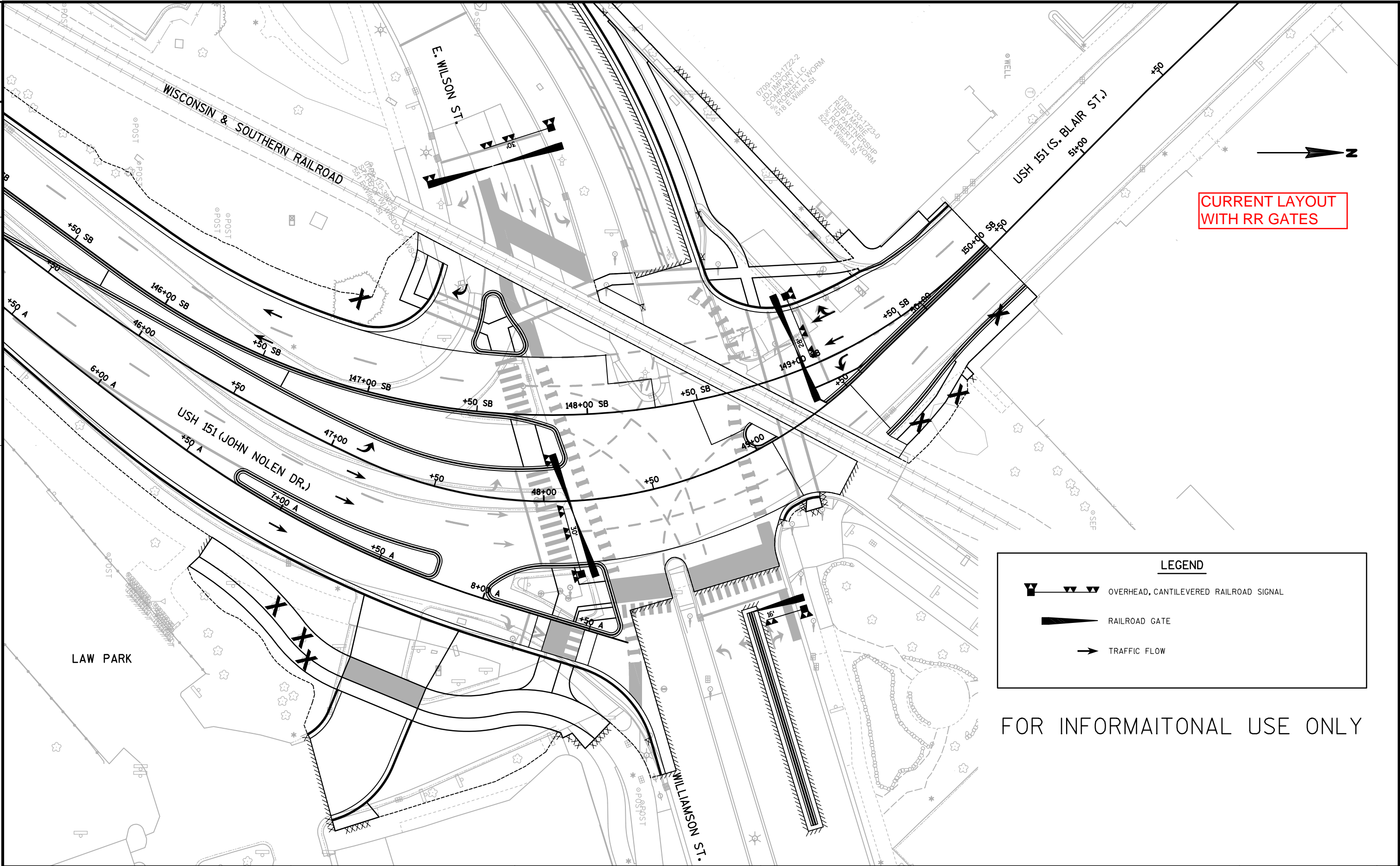

OPTION 1 - ULTIMATE LAYOUT  
ON-STREET CYCLE TRACK WITH MULTI-  
USE PATH ALTERNATE, IF PREFERRED

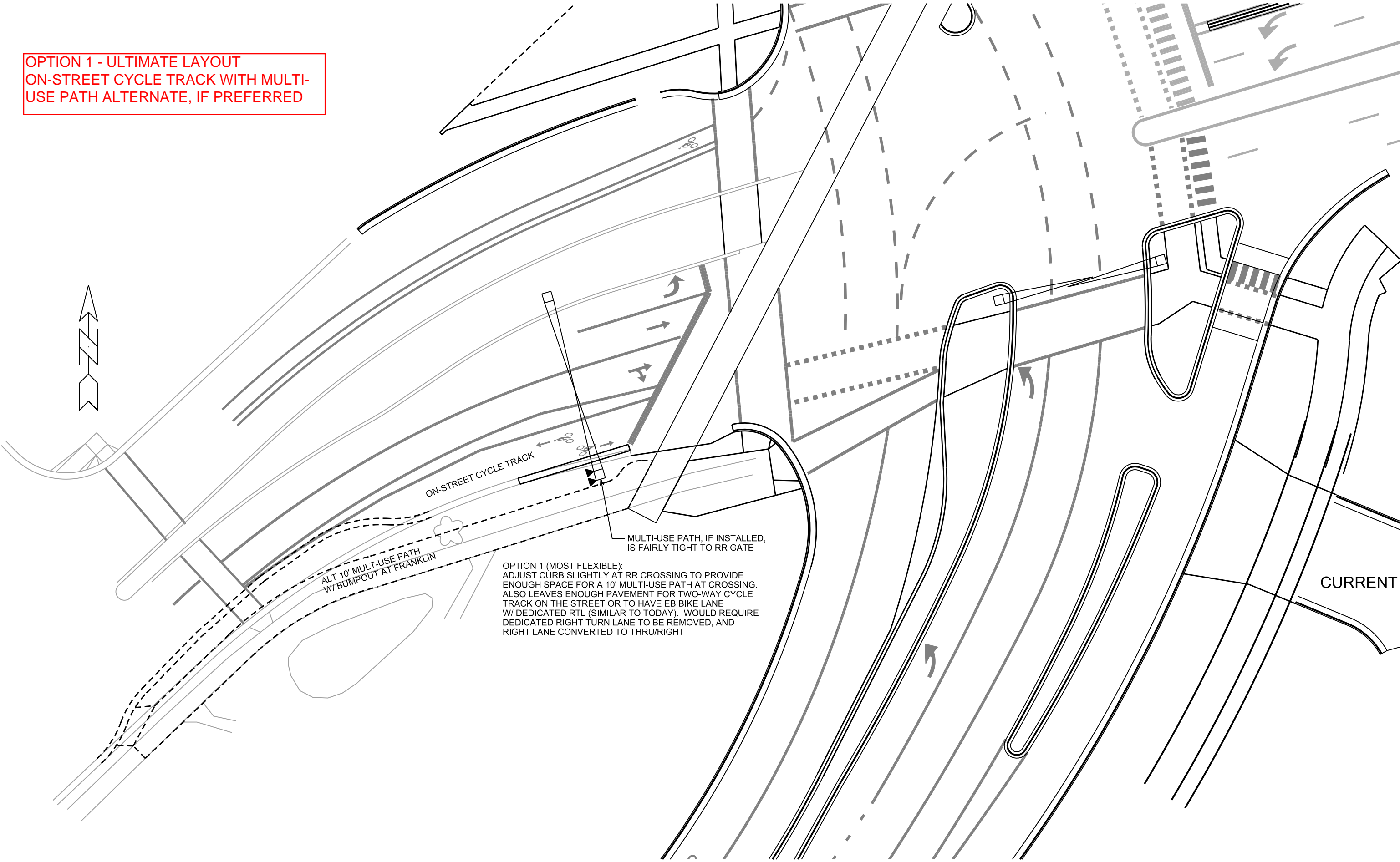

OPTION 1 - INTERIM; WORK  
TO BE COMPLETED WITH  
PROJECT

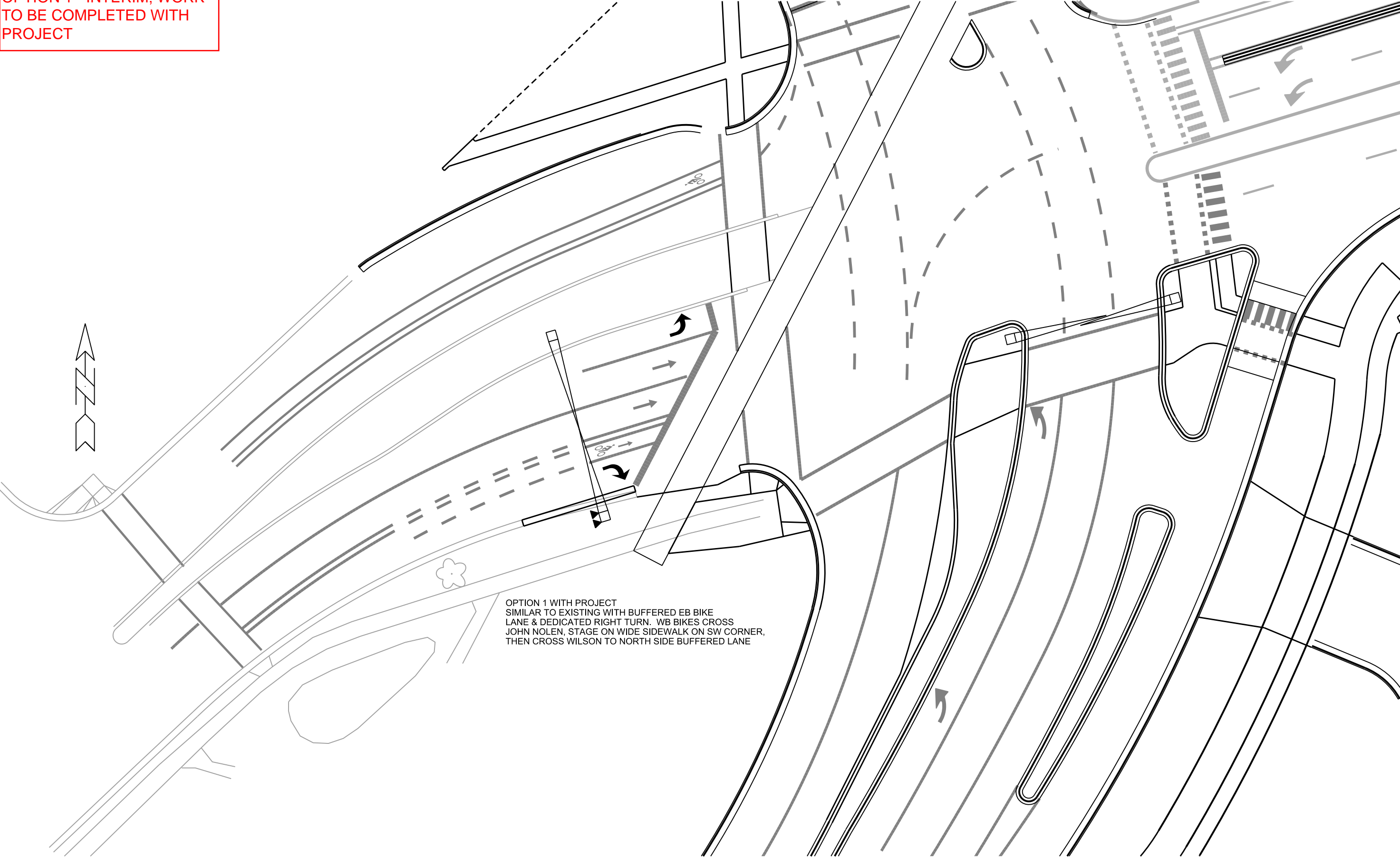

OPTION 1 WITH PROJECT  
SIMILAR TO EXISTING WITH BUFFERED EB BIKE  
LANE & DEDICATED RIGHT TURN. WB BIKES CROSS  
JOHN NOLEN, STAGE ON WIDE SIDEWALK ON SW CORNER,  
THEN CROSS WILSON TO NORTH SIDE BUFFERED LANE



OPTION 2 - ULTIMATE LAYOUT  
OFF-STREET CYCLE TRACK WITH  
SEPARATE SIDEWALK

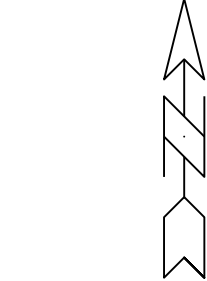

FRANKLIN

OPTION 2:  
MOVE CURB OUT TO NARROW EB WILSON ST AND TO RELOCATE  
RR GATE. PROVIDES SPACE FOR SEPARATE 5' SIDEWALK AND  
10' CYCLE TRACK, AND MORE SPACE TO RR GATE. THIS OPTION  
WOULD REQUIRE MOVING THE SIDEWALK BACK INTO THE EXISTING  
GREEN SPACE AND WOULD NEED EASEMENT FROM WATER UTILITY,  
BUT MAIN LANDSCAPED AREA COULD REMAIN. LESS FLEXIBLE AS  
WOULD NOT PROVIDE ENOUGH ON-STREET SPACE FOR TWO-WAY  
CYCLE TRACK, IF DESIRED IN THE FUTURE

OPTION 2 - INTERIM; WORK  
TO BE COMPLETED WITH  
PROJECT

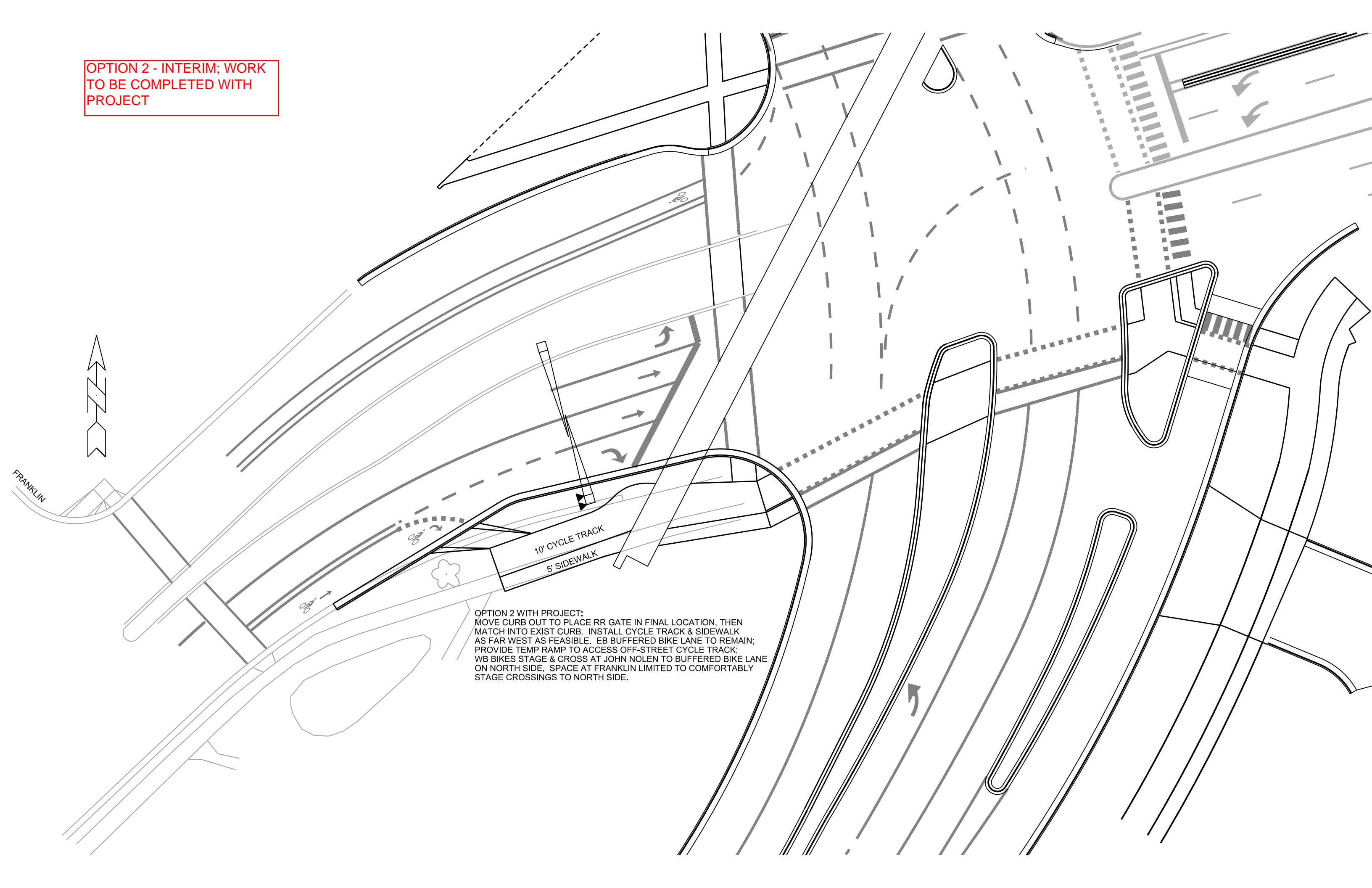

OPTION 2 WITH PROJECT:  
MOVE CURB OUT TO PLACE RR GATE IN FINAL LOCATION, THEN  
MATCH INTO EXIST CURB. INSTALL CYCLE TRACK & SIDEWALK  
AS FAR WEST AS FEASIBLE. EB BUFFERED BIKE LANE TO REMAIN;  
PROVIDE TEMP RAMP TO ACCESS OFF-STREET CYCLE TRACK;  
WB BIKES STAGE & CROSS AT JOHN NOLEN TO BUFFERED BIKE LANE  
ON NORTH SIDE. SPACE AT FRANKLIN LIMITED TO COMFORTABLY  
STAGE CROSSINGS TO NORTH SIDE.